

# JOINSCAN LEDs

S.56A 0.56 INCH ( 14.2mm ) SINGLE DIGIT 19.0 X 12.54 X 8.0mm

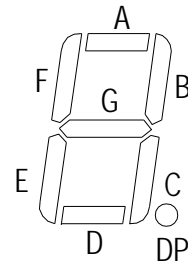

UNIT : mm  
TOLERANCE : ±0.2mm  
—▷ = GREEN  
—▷ = ORANGE RED

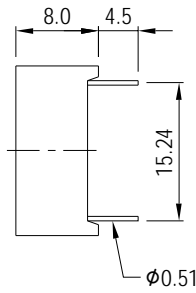
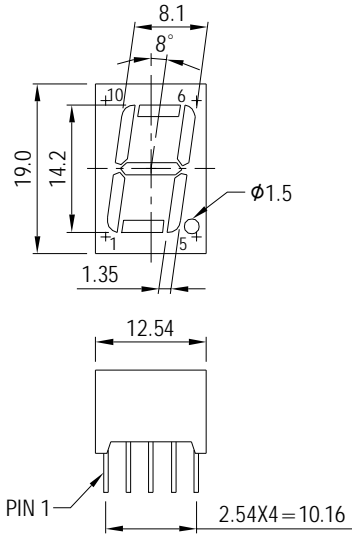
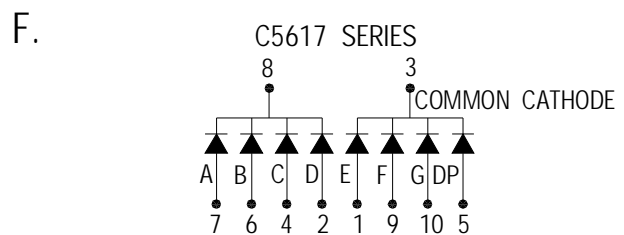
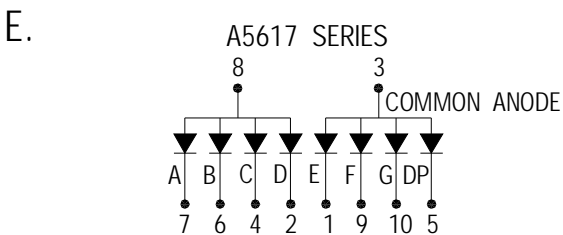
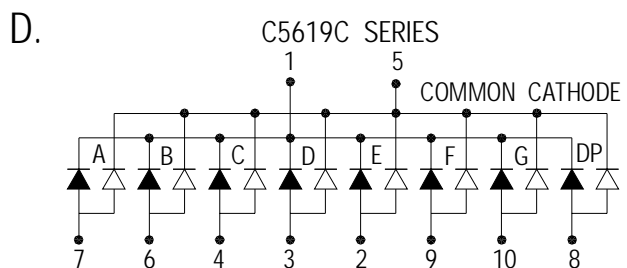
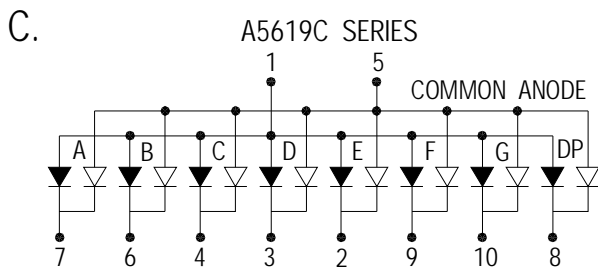
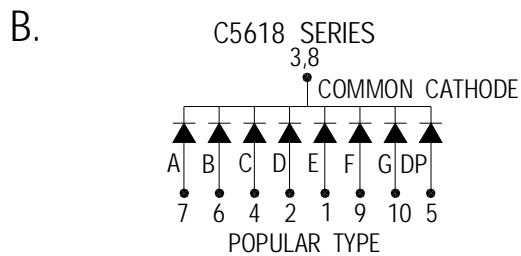
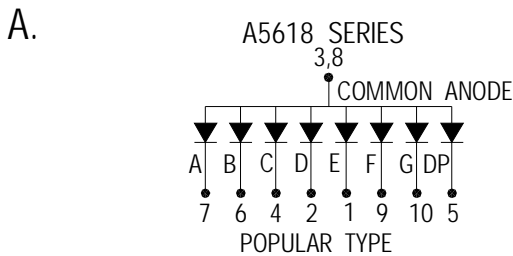

PIN FUNCTION	COMMON ANODE			COMMON CATHODE			WAVE LENGTH (nm)	IR MAX (uA) VR=5V	VF (V) IF=20mA	LUMINOUS INTENSITY IF=20mA
	A	C	E	B	D	F				
Emitting COLOR	model no.	model no.	model no.	model no.	model no.	model no.				
GaP RED	A5618H		A5617H	C5618H		C5617H	695	100	2.2	0.4mcd
GaAsP ORANGE RED	A5618O	A5619C	A5617O	C5618O	C5619C	C5617O	630	100	2.0	2.5mcd
GaP GREEN	A5618G		A5617G	C5618G		C5617G	570	100	2.2	4.5mcd
Gap Yellow	A5618Y		A5617Y	C5618Y		C5617Y	600	100	2.2	2.5mcd
GaAlAs SUPER RED	A5618RS		A5617RS	C5618RS		C5617RS	650	100	1.8	3.0mcd
GaAlAs ULTRA RED										
GaAlAs YELLOW GREEN										
Sic BLUE	A5618SF		A5617SF	C5618SF		C5617SF	465±5	100	3.6	5.0mcd
ZnSe WHITE										

Model No. -BW BLACK SURFACE WHITE SEGMENT  
-BR BLACK SURFACE RED SEGMENT  
-GW GRAY SURFACE WHITE SEGMENT

Remark :

1. Typical forward current 10-20mA, MAXimum forward current 25mA
2. Solder Temperature 1.6mm Below Seating plane less 5 seconds at 260°C +5°C -30°C
3. Peak Forward current Per Dice, Duty cycle 1/10, 10KHZ, MAXimum 120mA
4. Operating Temperature From -25°C to 85°C
5. RoHS COMPLIANT

REV : B