

JOINSCAN LEDs

T.49A 0.49 INCH (12.4mm) TRIAD DIGIT SMALL SIZE 25.0 X 19.0 X 8.0mm 22 PINS

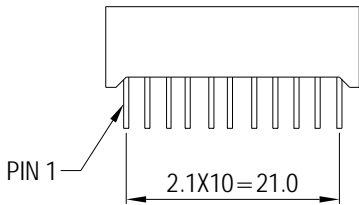
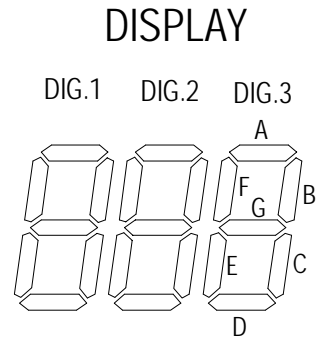
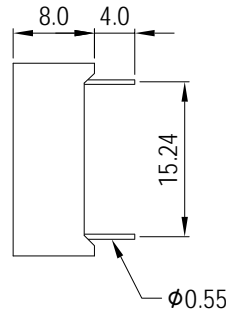
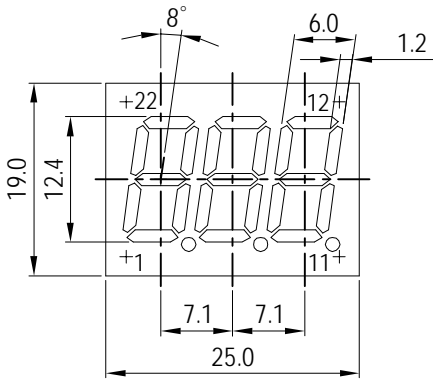

UNIT : mm
TOLERANCE : ±0.2mm

A. A4938 SERIES

B. C4938 SERIES

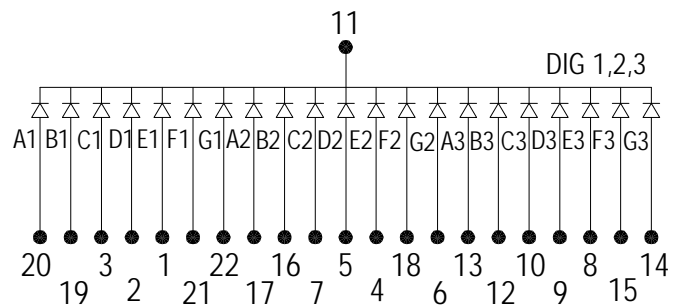
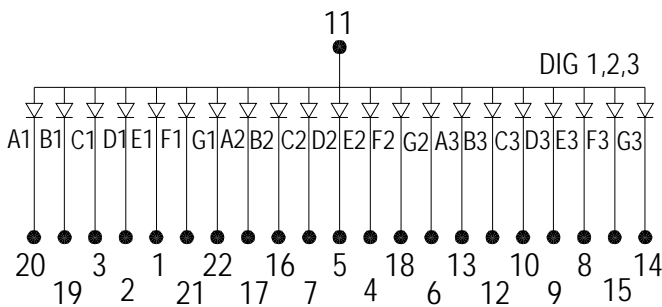

PIN	FUNCTION	COMMON ANODE		COMMON CATHODE		WAVE LENGTH (nm)	IR MAX (uA) VR=5V	VF (V) IF=20mA	LUMINOUS INTENSITY IF=20mA
		A	C	B	D				
	Emitting COLOR	model no.	model no.	model no.	model no.				
	GaP RED	A4938H		C4938H		695	100	2.2	0.6mcd
	GaAsP ORANGE RED	A4938O		C4938O		635	100	2.0	4.0mcd
	GaP GREEN	A4938G		C4938G		570	100	2.2	4.5mcd
	Gap Yellow	A4938Y		C4938Y		600	100	2.2	4.0mcd
	GaAlAs SUPER RED	A4938RS		C4938RS		650	100	1.8	8.0mcd
	GaAlAs ULTRA RED								
	GaAlAs YELLOW GREEN								
	Sic BLUE	A4938SF		C4938SF		465±5	100	3.6	15mcd
	ZnSe WHITE								

Model No. -BW BLACK SURFACE WHITE SEGMENT
-BR BLACK SURFACE RED SEGMENT
-GW GRAY SURFACE WHITE SEGMENT

Remark :

1. Typical forward current 10-20mA , MAXimum forward current 25mA
2. Solder Temperature 1.6mm Below Seating plane less 5 seconds at 260°C +5°C -30°C
3. Peak Foward current Per Dice , Duty cycle 1/10 , 10KHZ , MAXimum 120mA
4. Operating Temperature From -25°C to 85°C

5. RoHS COMPLIANT

REV : B