

JOINSCAN LEDs

DD40A 0.4 INCH (10.1mm) 2.5 DIGITS 20.2 X 16.0 X 7.0mm 16PINS

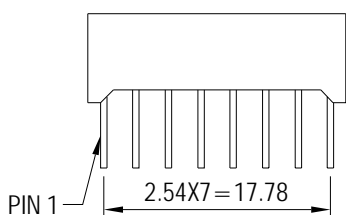
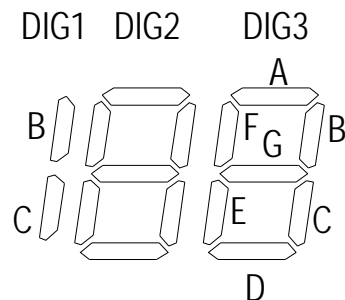
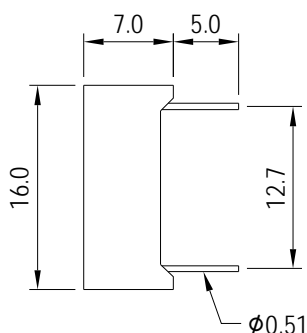
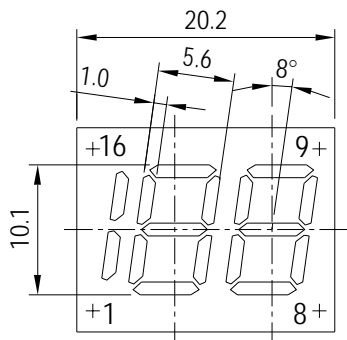

UNIT : mm
TOLERANCE : ±0.2mm

A. A4136 SERIES

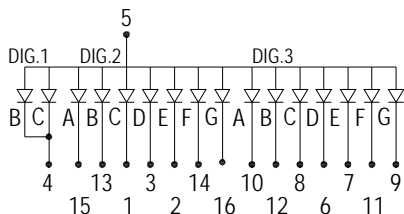

C. A4135 SERIES

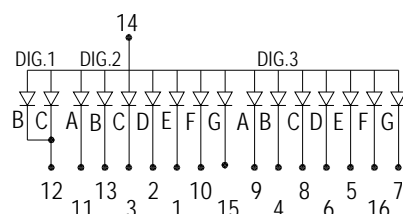

B. C4136 SERIES

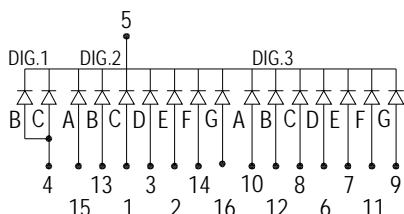

D. C4135 SERIES

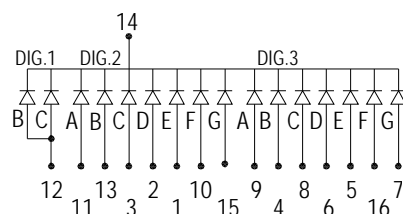

PIN FUNCTION	COLOR	COMMON ANODE			COMMON CATHODE			WAVE LENGTH (nm)	IR MAX (uA) VR=5V	VF (V) IF=20mA	LUMINOUS INTENSITY IF=20mA
		model no.	model no.	model no.	model no.	model no.	model no.				
Emitting	RED	A4136H	A4135H		C4136H	C4135H	695	100	2.2	0.4mcd	
	ORANGE RED	A4136O	A4135O		C4136O	C4135O	635	100	2.0	2.5mcd	
	GREEN	A4136G	A4135G		C4136G	C4135G	570	100	2.2	4.5mcd	
	Yellow	A4136Y	A4135Y		C4136Y	C4135Y	600	100	2.2	2.5mcd	
	SUPER RED	A4136RS	A4135RS		C4136RS	C4135RS	650	100	1.8	3.0mcd	
	ULTRA RED										
	YELLOW GREEN										
	BLUE	A4136F	A4135F		C4136F	C4135F	430	100	3.6	2.5mcd	
	WHITE										

Model No. -BW BLACK SURFACE WHITE SEGMENT
-BR BLACK SURFACE RED SEGMENT
-GW GRAY SURFACE WHITE SEGMENT

Remark :

1. Typical forward current 10-20mA, MAXimum forward current 25mA
2. Solder Temperature 1.6mm Below Seating plane less 5 seconds at 260°C +5°C -30°C
3. Peak Forward current Per Dice, Duty cycle 1/10, 10KHZ, MAXimum 120mA
4. Operating Temperature From -25°C to 85°C
5. RoHS COMPLIANT

REV : C